

DESCRIPTION	STATUS	SIZE	REQD	MODEL	SUPPLIER/MANUFACTURER
2 SERVICE COLD DELI	NEW	8'-1"x4'-3"x4'-6"	1	PID-BR-RRS-54-Deli	HILL PHOENIX
3 SELF-SERVE COLD DELI	NEW	8'-0"x3'-8"x4'-7"	3	PI-BR-54-Deli-PR	HILL PHOENIX
4 SELF-SERVE REFRIGERATED BAKERY	NEW	6'-1"x3'-8"x6'-0"	1	PI-BR-72-Bakery	HILL PHOENIX
5 DOOR REACH IN FROZEN BAKERY	NEW	12'-6"x3'-8"x6'-10"	1	QIV514	KYSOR WARREN
9 SELF-SERVE COLD DELI	NEW	8'-1"x3'-8"x6'-0"	2	PI-BR-72-Deli	HILL PHOENIX
13 WING BAR	RELO FM ST #477	2'-8" x 5'-1" x 4'-8"	1	MTF604M-FF	ATLANTIC HOT FOOD BARS
18 CONVECTION HOT DELI	NEW	2'-11"x 8'-0" x 4'-6"	1	PI-BR-54	HILL PHOENIX
24 SERVICE HOT DELI	NEW	3'-8" x 1'-0" x 5'-1"	1	BMD-H	HILL PHOENIX
160 FLORAL	NEW	4'-3"x3'-6"x6'-9"	1	PF-4R	KYSOR WARREN
161 PRODUCE MULTI-DECK	NEW	8'-1"x3'-8"x6'-8"	1	DX6LN	KYSOR WARREN
162 PRODUCE MULTI-DECK	NEW	12'-1"x3'-8"x6'-8"	4	DX6LN	KYSOR WARREN
163 PRODUCE MULTI-DECK W/ DOORS	NEW	12'-1"x3'-8"x6'-8"	1	DX6LD	KYSOR WARREN
164 REFRIGERATED SLANT BIN	RELO FM ST #1575	4'-0"x4'-5"x4'-1" H	1	RB5044	JSI
165 REFRIGERATED SLANT BIN - REAR SHELVING	RELO FM ST #1575	3'-0"x4'-5"x4'-1" H	1	RB5033	JSI
166 REFRIG. BIN SLANT	RELO FM ST #1575	6'-5"x3'-0"x4'-2" H	4	RB5036	JSI
*** DISPLAYS ***					
180 FRESH TO FRONT DISPLAY	NEW	3'-2"x3'-0"x3'-8" H	1	SA0821	JSI
181 BANANA TABLE	RELO FM ST #1575	5'-5"x5'-5"x4'-0" H	1	SA0701-A	JSI
182 TOMATO ISLAND	RELO FM ST #1575	5'-0"x5'-0"x2'-0" H	1	EC0749-D	JSI
183 WRAP AROUND END CAP	RELO FM ST #1575	5'-11"x2'-0"x4'-1" H	1	EC0698-E	JSI
184 WRAP AROUND END CAP	RELO FM ST #1575	5'-11"x2'-0"x4'-1" H	2	EC0698-E	JSI
185 SPIGE RACK END CAP	RELO FM ST #1575	5'-11"x1'-3"x4'-1" H	1	SB0188-1	JSI
186 ORCHARD DUMP BIN	RELO FM ST #1575	13'-0"x2'-0"x2'-7" H	2	B01591-A	JSI
187 FLORAL FIXTURE	RELO FM ST #1575	-----	1	FD0483	JSI
188 WRAP AROUND END	RELO FM ST #1575	-----	1	EC0705	JSI
189 PRODUCE SPIGE RACK	RELO FM ST #1575	-----	1	SR0101-A	JSI
190 CASE EXTENDER	RELO FM ST #1575	-----	4	P00801-E	JSI
191 EURO TABLE	RELO FM ST #1575	-----	4	ET0315-A	JSI
192 BAKERY TABLE	NEW	4'-1"x5'-5"x2'-11" H	3	NT0213-D	JSI
193 SATELLITE TABLE	NEW	2'-10"x2'-10"x4'-6" H	3	BM0101-A	JSI
194 LOCAL RACK	RELO FM ST #1665	-----	1	BM0355-B	JSI
*** TABLES ***					
30 SLICER STAND	NEW	2'-1"x2'-2"x2'-8"	2	S25	M&E MANUFACTURING CO.
33.1 S.S. TABLE W/ BKSPASH, BOTTOM SHELF, 2 DRAWERS	NEW	5'-0"x2'-6"x2'-10" H	1	SI6R5-3060SSW-2D-FL	JOHN BOOS & COMPANY
33.2 S.S. TABLE W/ BKSPASH, MIDDLE SHELF, 2 DRAWERS	NEW	5'-0"x2'-6"x2'-10" H	5	SI6R5-3072SSW-2D-FL	JOHN BOOS & COMPANY
*** BOAT RACKS ***					
37A BOAT RACKS	EXISTING	-----	1	-----	-----
37.1 BOAT RACK W/2 SHLS, 2 PPR HOLDERS, CEILING MTD	NEW	8'-0"x1'-8"x2'-5" H	1	MBR6200-2SH-CM-FL	JOHN BOOS & COMPANY
37.2 BOAT RACK ENCLOSED, WALL MOUNTED	NEW	8'-0"x1'-8"x2'-0" H	2	FI-WCS60	JOHN BOOS & COMPANY
37.3 BOAT RACK W/2 SHLS, 2 PPR HOLDERS, WALL MNTD	NEW	5'-0"x1'-8"x2'-0" H	2	MBR6200-2SH-FL	JOHN BOOS & COMPANY
37.4 BOAT RACK W/2 SHLS, 2 PPR HOLDERS, WALL MNTD	NEW	4'-0"x1'-8"x2'-0" H	1	MBR4820-2SH-FL	JOHN BOOS & COMPANY
*** STORAGE RACKS ***					
40 DUNNAGE RACK - 1 SHELF, SOLID SLAT ALUM	NEW	4'-0"x1'-8"x1'-0" H	1	DASQ-4-1220	WIN-HOLT
41.1 COOLER RACK - 2 SHELVES, SOLID SLAT ALUM (P)	NEW	4'-0"x1'-8"x5'-0" H	2	ALSCH-48-220	WIN-HOLT
41.2 COOLER RACK - 3 SHELVES, SOLID SLAT ALUM (P)	NEW	5'-0"x1'-8"x5'-0" H	9	ALSCH-60-320	WIN-HOLT
41.3 COOLER RACK - 2 SHELVES, SOLID SLAT ALUM (D/B)	NEW	5'-0"x1'-8"x5'-0" H	1	ALSCH-60-220	WIN-HOLT
*** COOLER AND FREEZER ***					
45A WALK-IN-COOLER - DELI/BAKERY	EXISTING	-----	1	-----	-----
46A WALK-IN-FREEZER - DELI/BAKERY	EXISTING	-----	1	-----	-----
170A WALK-IN-COOLER - PRODUCE	EXISTING	-----	1	-----	-----
*** ELECTRIC COOKING/HOLDING EQUIPMENT ***					
48A SINGLE RACK OVEN - ELECTRIC	EXISTING	-----	1	-----	-----
49 FRYER AND FILTER (SEE NOTE No. 2)	NEW	2'-0" x 3'-0" x 4'-1"	1	BLFF-208/60/3	BKI
50 BASKET FRYER	NEW	1'-4"x2'-11"x4'-1"	2	GBF-50	GILES
51A PROOFER CABINET (2 DOOR)	EXISTING	-----	1	-----	-----
52 ROTISSERIE W/ STAND AND VENTLESS HOOD	NEW	3'-5"x2'-11"x5'-9"	1	VGG-8 W/VGH-8	BKI
93 CONVECTION OVEN	NEW	3'-2"x3'-1"	1	SHO-E	BLODGETT
*** ELECTRIC PREP EQUIPMENT ***					
53 SLICERS - AUTOMATIC	NEW	12'-1"x2'-8"x2'-1"	1	GSP HD	BIZERBA
54 SLICERS - MANUAL	NEW	2'-11"x2'-8"x2'-1"	2	GSPH33	BIZERBA
55 WRAPPING MACHINE - SINGLE ROLL W/MOUNTING AXLE	NEW	2'-5"x1'-11"x0'-5"	2	625-AI	HEAT SEAL
64 BREAD SLICER	NEW	1'-1"x2'-4"x1'-0"	1	M6	BERKEL
56 SCALE W/BUILT IN PRINTER	NEW	1'-3"x1'-5"x1'-0"	4	H11-7LS	HOBART
57 FLY TRAP (SEE NOTE No. 8)	NEW	2'-3"x1'-0"x0'-4"	3	225G	GILBERT
68 REFRIGERATED BREADING STATION - 48"	NEW	2'-9" x 3'-10" x 4'-0"	1	9148W	UNIFIED BRANDS
99 PREMIUM MISTING SYSTEM W/ REVERSE OSMOSIS SYTM	NEW	-----	1	PMC/R0300	PRODEW
118 CAKE DECORATOR/PRINTER	NEW	1'-0" x 0'-8" x 0'-6"	1	PHOTOCAKE IV	DECO-PAC
*** NON-ELECTRIC PREP EQUIPMENT ***					
61 DESK (WALL MOUNTED)	NEW	2'-0"x2'-0"x1'-0"	1	RDWN-1	WIN-HOLT
63 TRASH CAN	NEW	-----	6	-----	-----
64 OVEN RACK (PLATTER CART)	NEW	-----	11	-----	-----
111 STERLOX FOOD SAFETY SYSTEM	NEW	-----	1	PRODUCE MAXX CC	PURICORE
115 STAINLESS STEEL WALL MOUNTED COAT RACK	NEW	2'-0"x4'-0"x8" H	1	1445-L-1017-HEF-101022-R0	HEFCO

- DELI/BAKERY GENERAL NOTES**
- THE GENERAL CONTRACTOR IS RESPONSIBLE FOR COMPLIANCE WITH ALL HEALTH DEPARTMENT REQUIREMENTS.
 - ACCESSORIES FOR PRESSURE FRYER: A. HEAVY DUTY CASTERS, B. FILTER HOSE.
 - PLUMBING CONTRACTOR IS TO INSTALL ALL SINKS AND EYE WASH UNITS.
 - THE MECHANICAL CONTRACTOR SHALL PROVIDE AND INSTALL MECHANICAL EQUIPMENT FOR THE DELI/BAKERY AS REQUIRED.
 - THE EQUIPMENT LISTED IN THE DELI/BAKERY EQUIPMENT SCHEDULE IS SUPPLIED BY FOOD LION, AND IS SET IN PLACE BY FOOD LION'S REFRIGERATION CONTRACTOR. THE GENERAL CONTRACTOR IS RESPONSIBLE FOR ALL ELECTRICAL, PLUMBING, AND H.V.A.C. EQUIPMENT CONNECTIONS.
 - THE GENERAL CONTRACTOR SHALL INSTALL THE BOAT RACKS THAT ARE PROVIDED BY FOOD LION. THE GENERAL CONTRACTOR SHALL COORDINATE THE EXACT LOCATION WITH A FOOD LION CONSTRUCTION MANAGER.
 - THE PAPER TOWEL HOLDERS ARE SUPPLIED BY FOOD LION AND INSTALLED BY THE GENERAL CONTRACTOR. INSTALL THE PAPER TOWEL HOLDERS AT 3'-6" ABOVE FINISHED FLOOR.
 - MOUNT FLY TRAPS AT 5'-0" ABOVE FINISHED FLOOR IN DELI/BAKERY AND PRODUCE PREP.
 - TWO ADDITIONAL 3" DIAMETER DISPLAY TABLES, MODEL No. 1810-1806-1, SHALL BE SUPPLIED IF THE STORE HAS A REFRIGERATED FLORAL DISPLAY.
 - THE GENERAL CONTRACTOR SHALL SUPPLY AND INSTALL TWO BROOM HANGERS AND THREE MOP HANGERS IN THE D/B CLOSET. ALSO SUPPLY AND INSTALL A 12"x36" SHELF IN THE CLOSET AT 6'-0" ABOVE FINISHED FLOOR. COORDINATE LOCATION OF THE SHELF AND HANGERS WITH FOOD LION IF NOT ALREADY INSTALLED.
 - THE GENERAL CONTRACTOR SHALL PROVIDE AND INSTALL A SYSTEM (3 ROWS OF 5 CLIPBOARD EACH) FOR HANGING FIFTEEN CLIPBOARDS ABOVE THE DESK IN THE DELI IF NOT ALREADY INSTALLED.

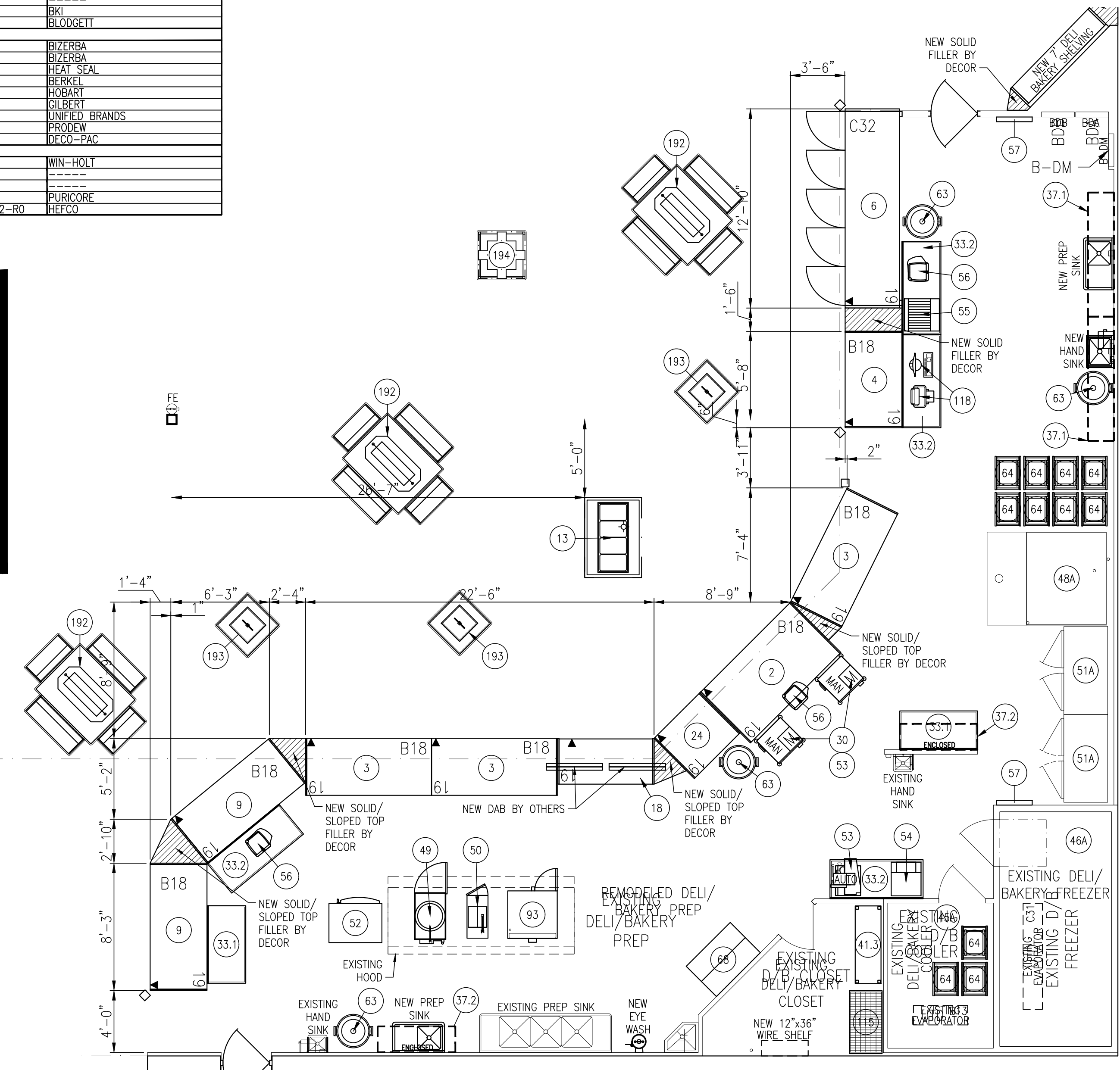

1 DELI/BAKERY FIXTURE PLAN
A4.01 SCALE: 3/16" = 1'-0"

2 PRODUCE FIXTURE PLAN
A4.01 SCALE: 3/16" = 1'-0"